

Modeling and
Scripting -Portfolio

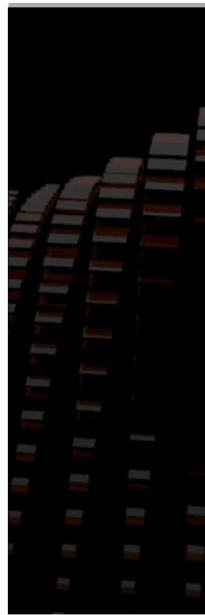

Yokesmarapa L S

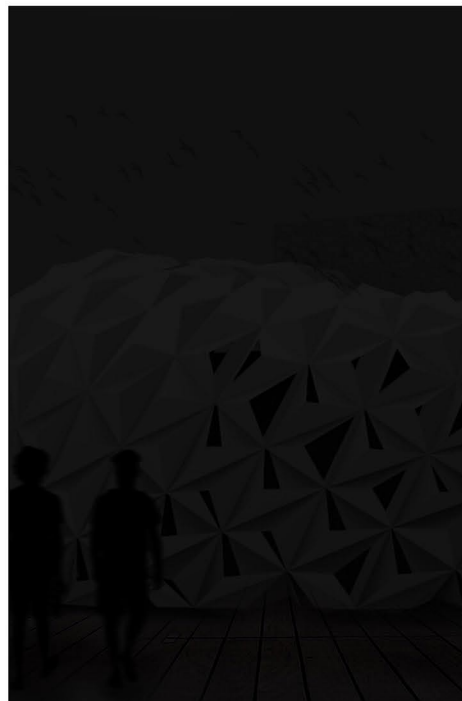
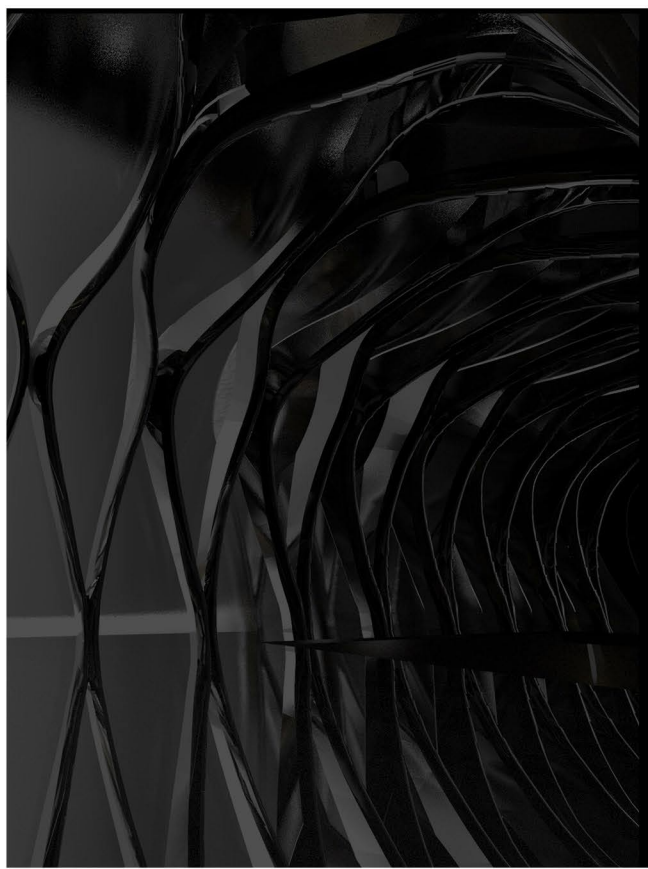
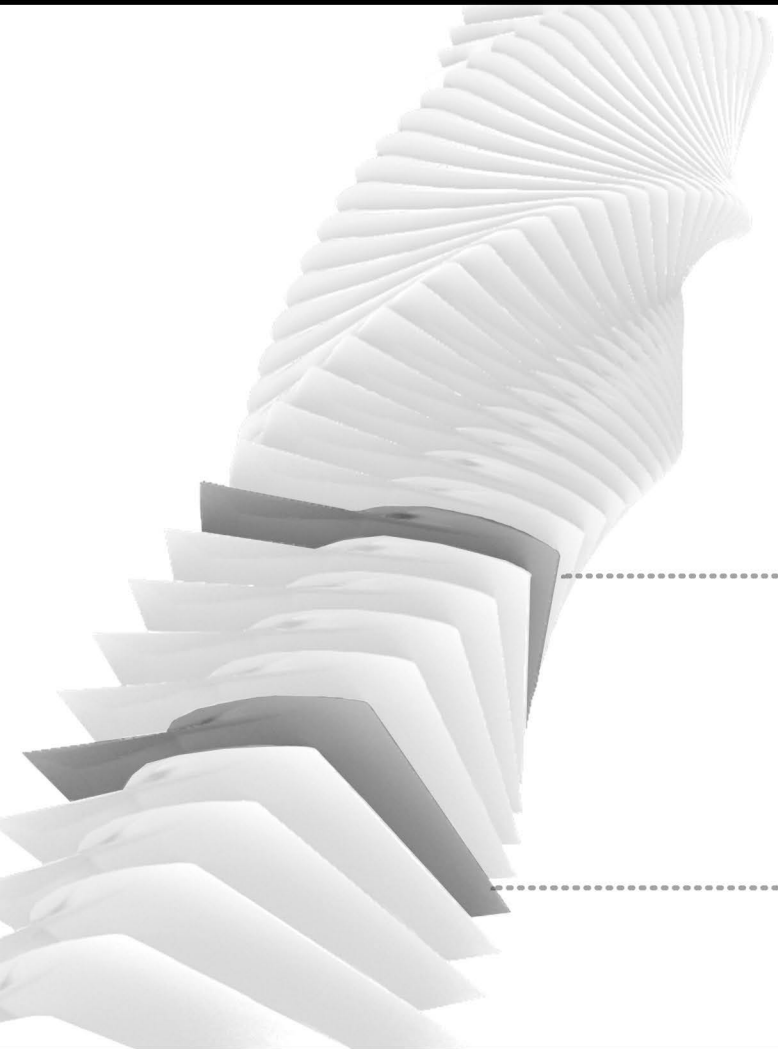

SubD modeling 1-2

Scripted models 3-7

contents

*With the newest feature introduced
to Rhino7 subD .*

SubD modelling

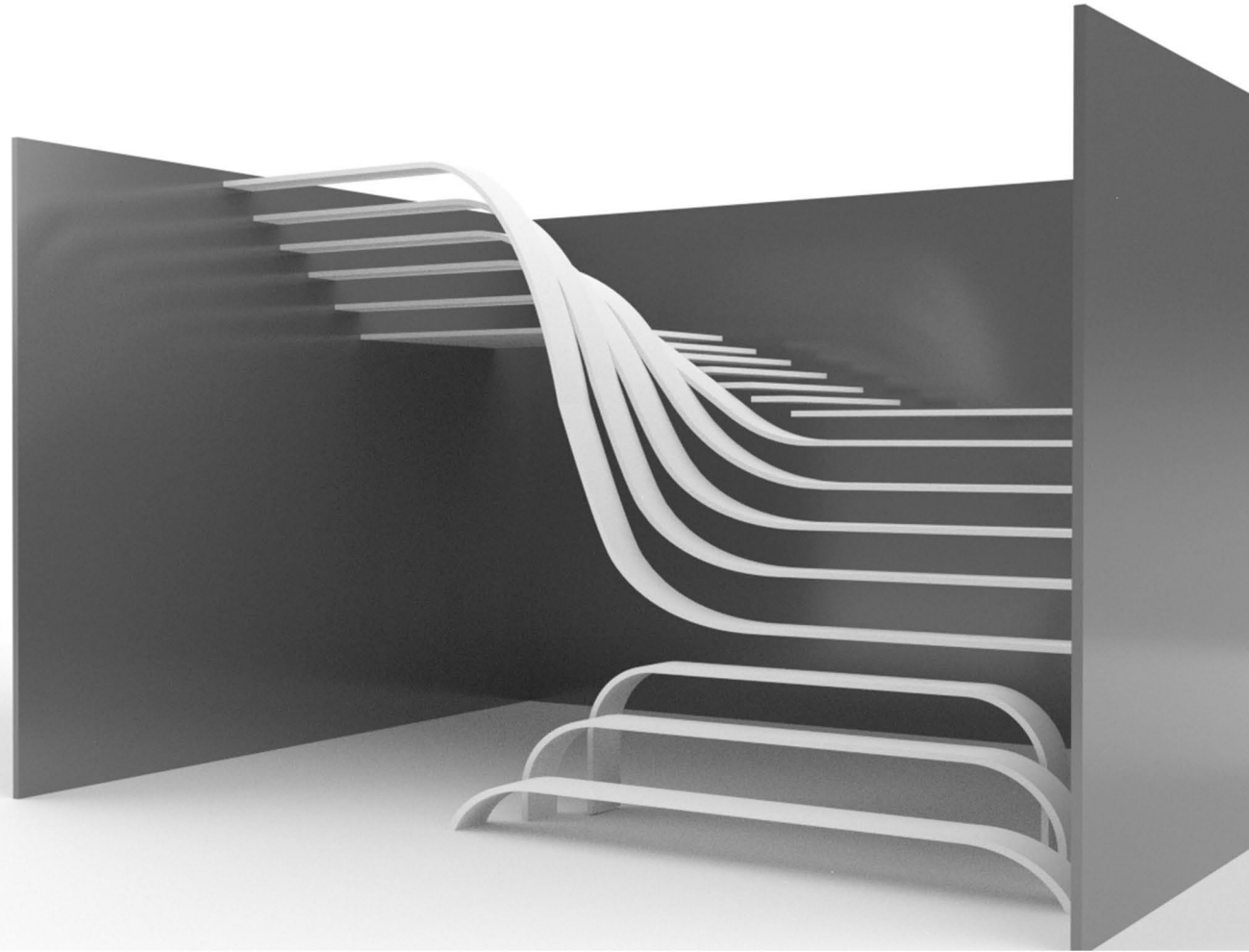

*With the newest feature introduced
to Rhino7 subD .*

SubD modelling

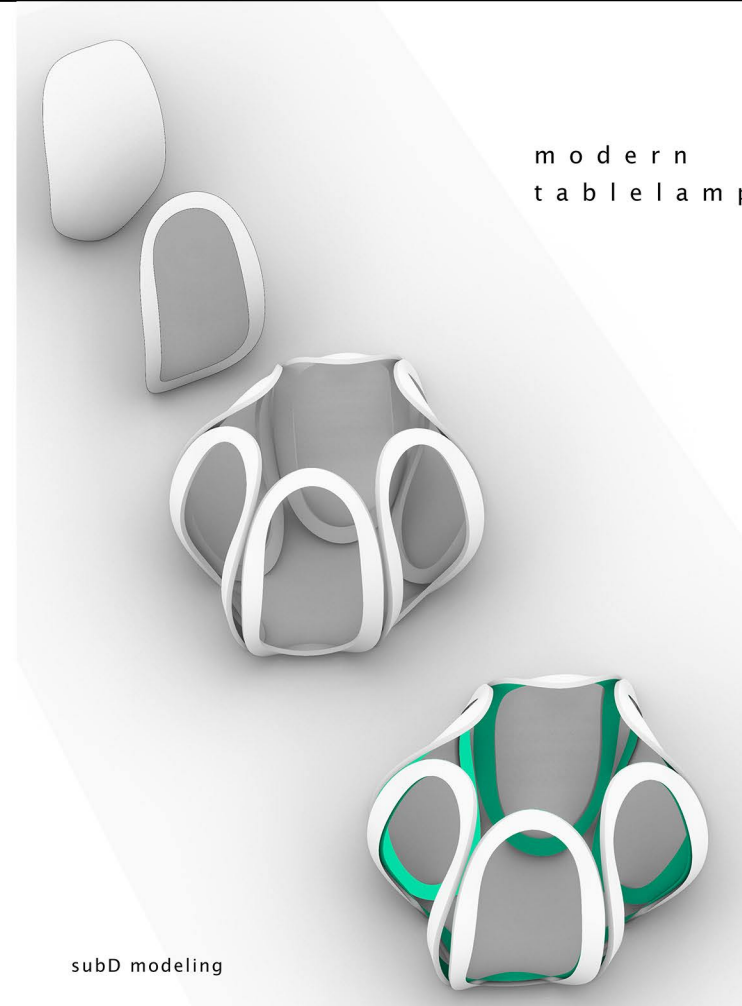

modern
table lamp



*Populate points a surface in a grid ,
Random points are placed with point charge
and made the points in the grid to
move in the direction of the charge vector.
Left the interpolated points of the old grid
points and dispersed points*

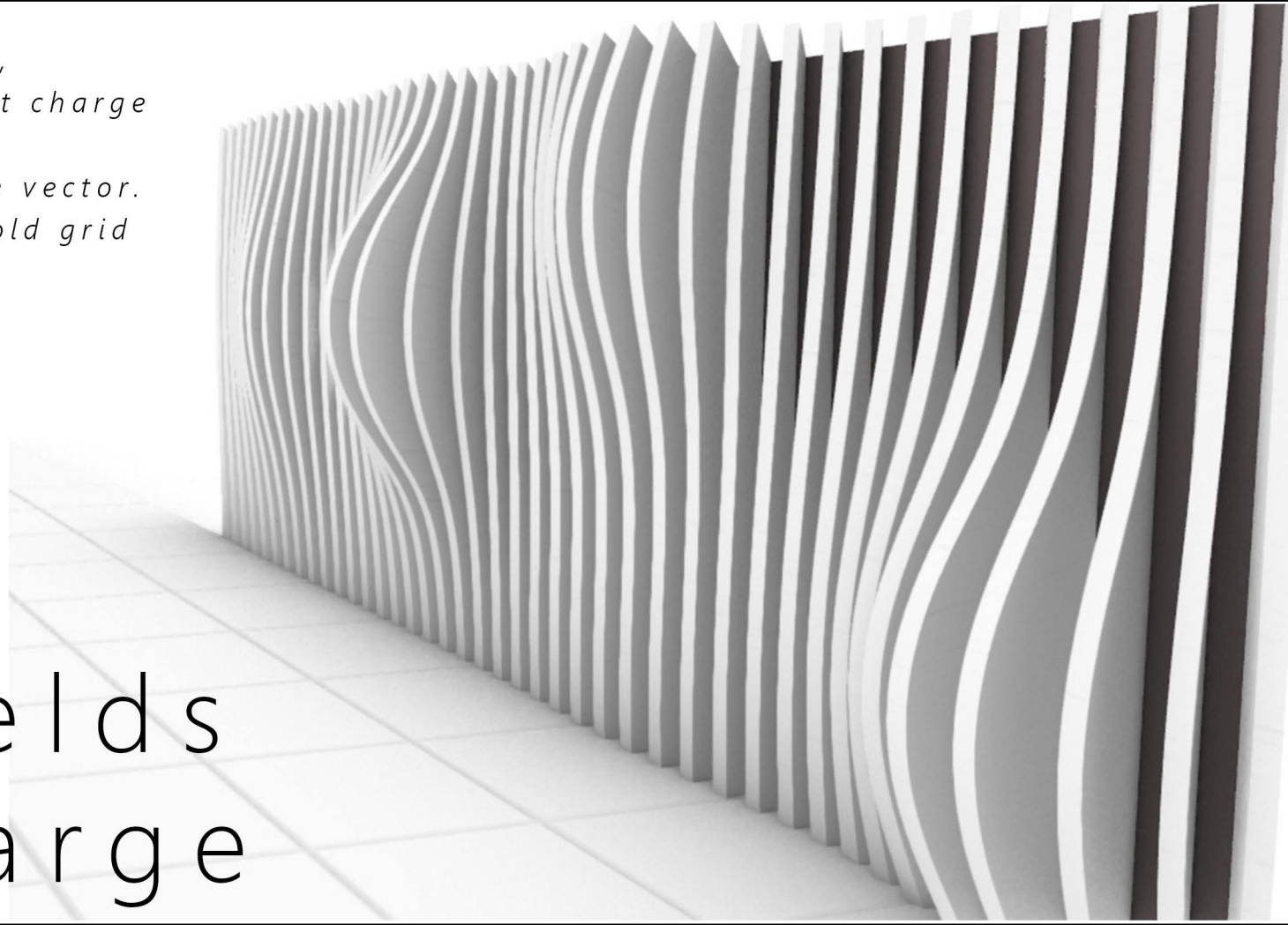

Vector Fields
Point charge

*Populated points on surface given
a circle to each, then divide the circle, each
points are then given spin and point charge.
The field lines are made into
nurbs curve given a extrusion using a graph
mapper.*

Spin charge & Point charge

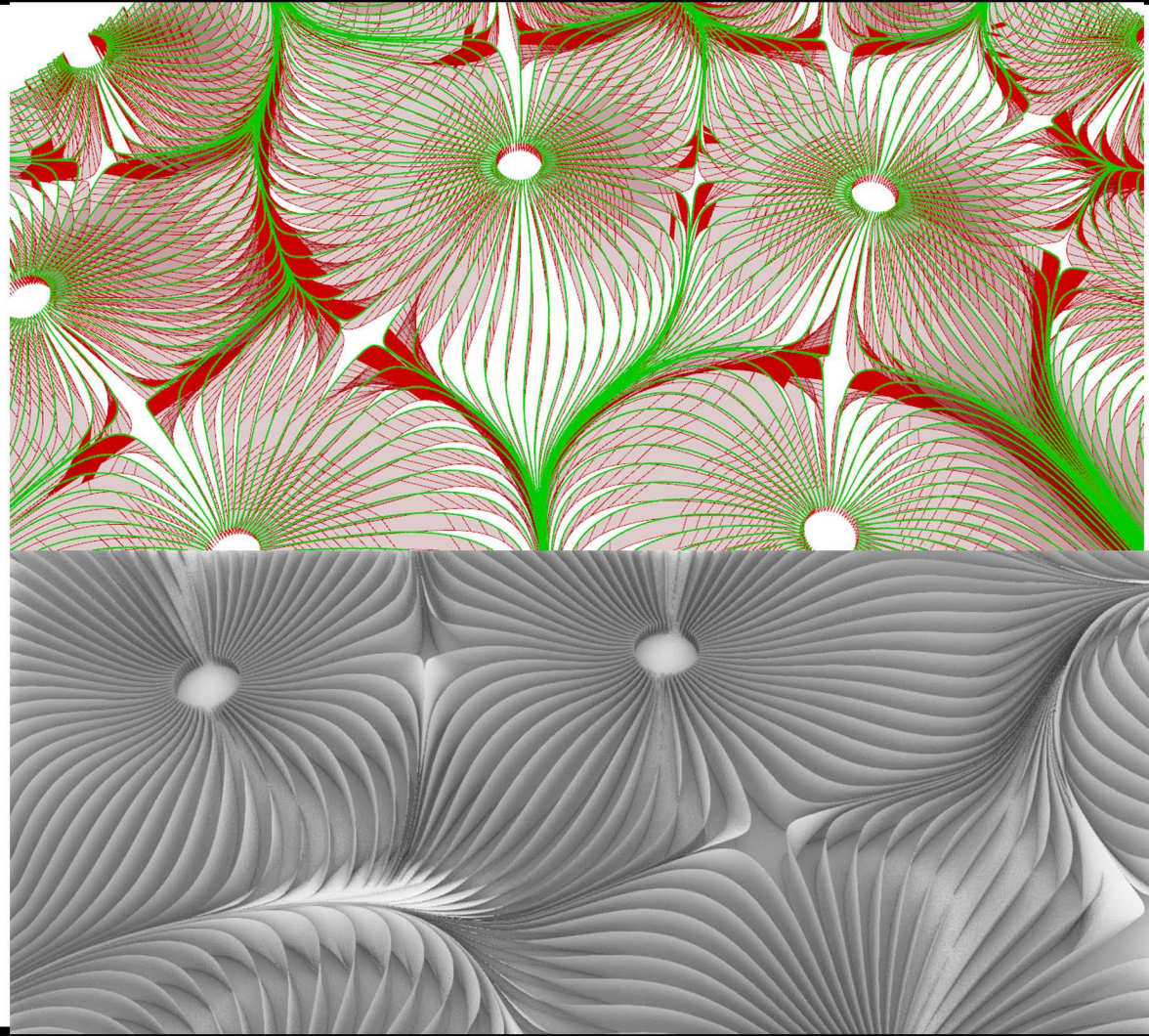

Array of cubes , made a spiral curve then piping gave certain cubes inside the pipe. Subtract the cubes using points in brep then use dispatch leaving two options , one with all cubes intact , second without the cubes on in the pipe then the percentage of the cubes are controlled to show some randomness.

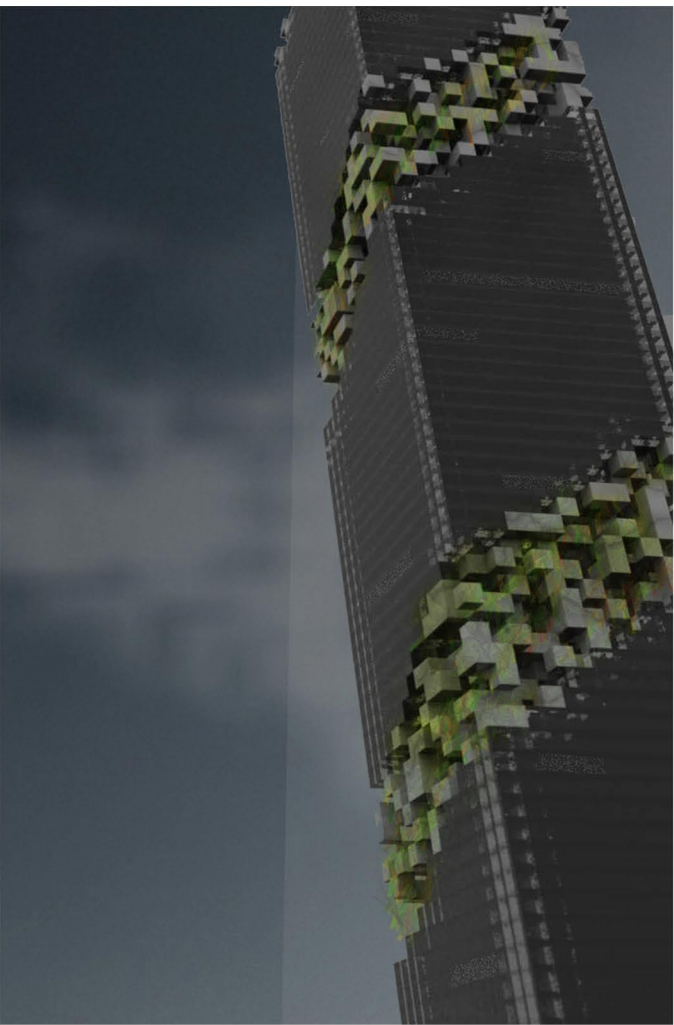
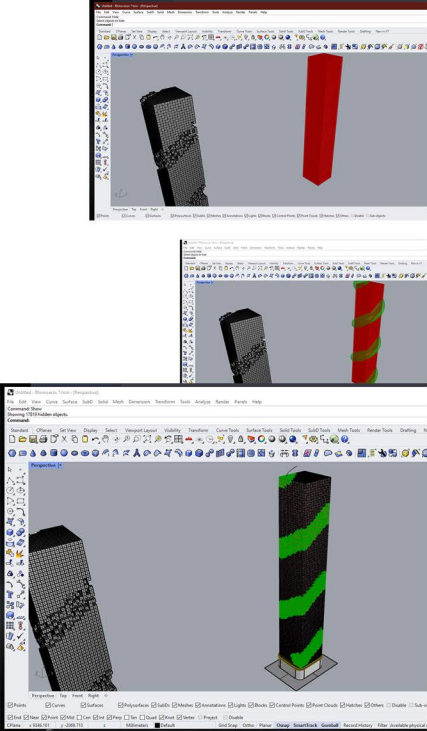

Points in brep - Dispatch

*Grid of points , gave an ataractor
point then used dispatch to find the
distance points less smaller
than a centain distance
and moved the poins in sine.*

Attractors & Dispatch

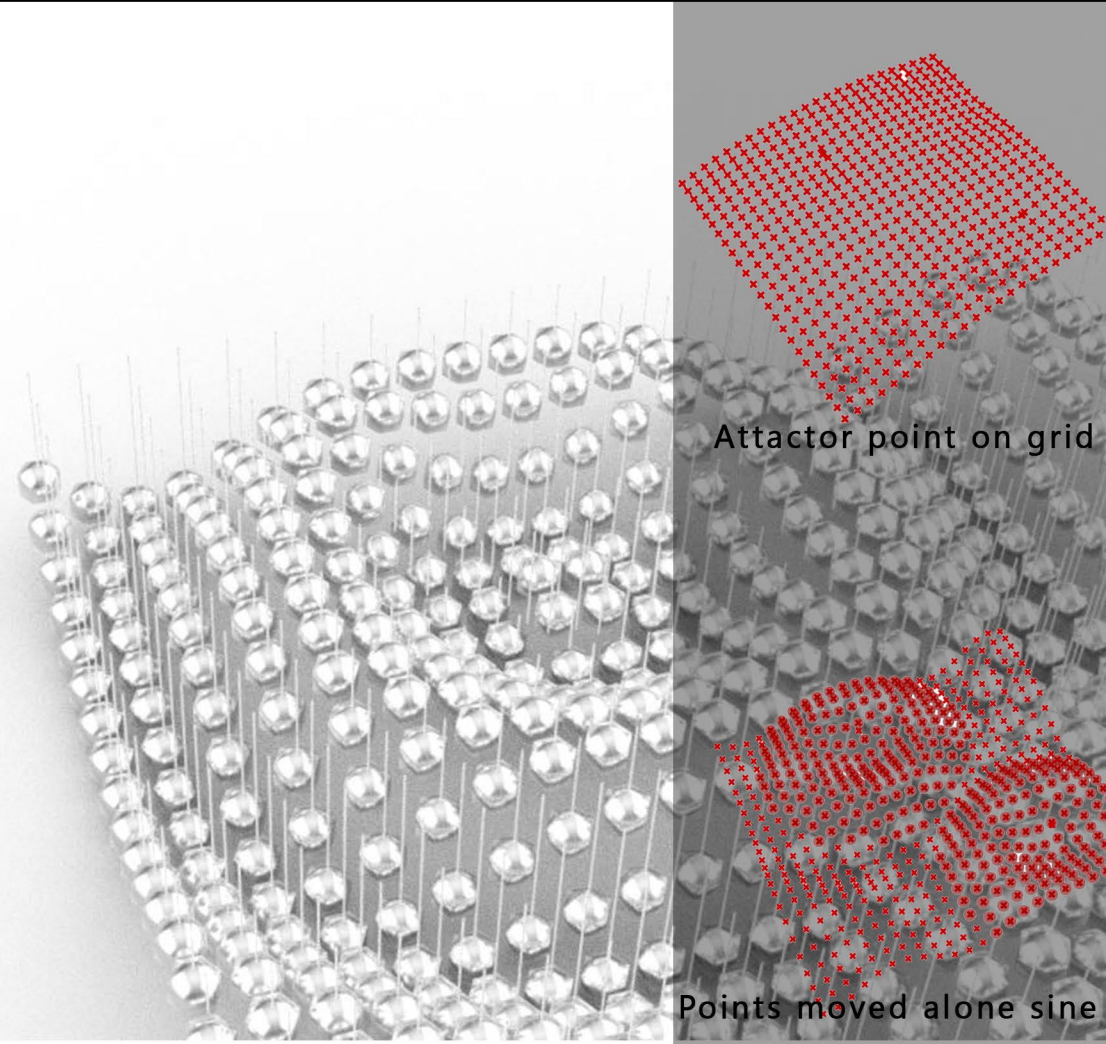

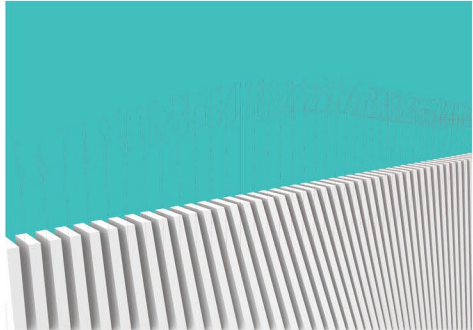

*Number every
panel face.*

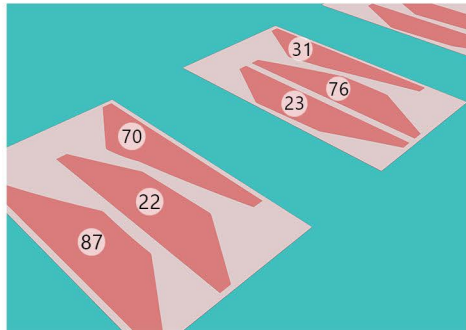

*Using open-Nest
optimising the pannels
to the maximum usage
of the base.*

Ready model
for CNC

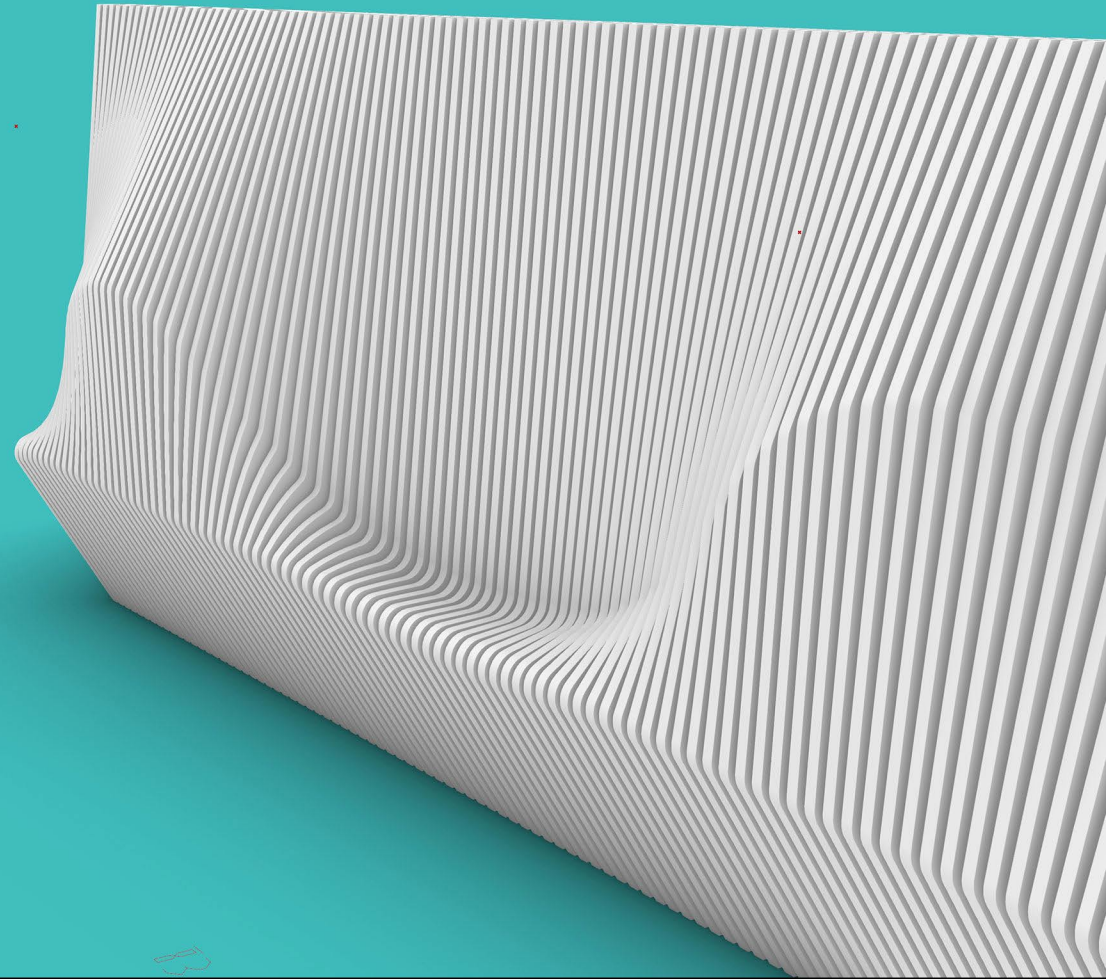

New facelift was given by ICF for the Vande Bharath, currently running Thiruvendram route. The design was inspired with the idea of a south indian bull and with many technical parameters

Vande Bharath Facelift



**renders generated through unreal engine 5*

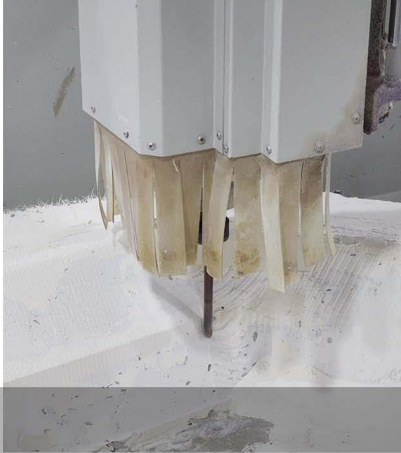

*Using 3 axis CNC mould is created from styroform and treated with silicon gel coating with hot adesives , layering them with vareies thick-ness of silicon mesh.
Once mould is prouced , pattern is created and trimmed of the unnessecery edges.*



Mold Fabrication



**photo taken from rhino viewport- Vande Bharath cockpit*



**View from vande Bharath cockpit*



**View from vande Bharath cockpit*



**scaled 3D print of VB train shell*

Fittings (FRP)

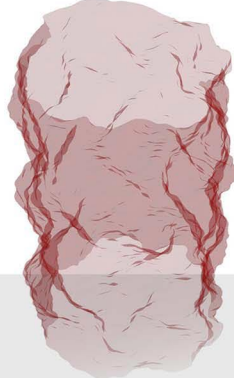
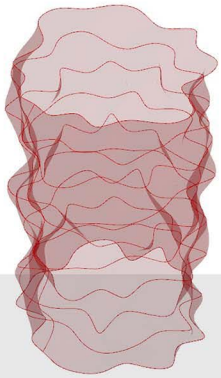
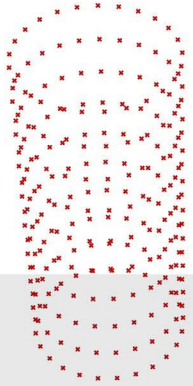

Series of points are constructed and for the cylinder and moving the individual points on the curve along the z axis to deform the cylinder and converting to mesh and creating a single spiral nurb line path generating the gcode for the printer.

Deforming cylinder and generating gcode



**rhino viewport screenshot with single spiral*

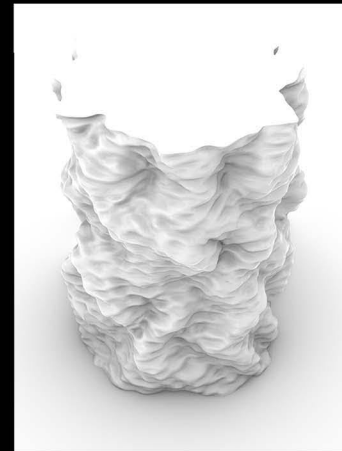

**rhino viewport screenshot of complete geo.*

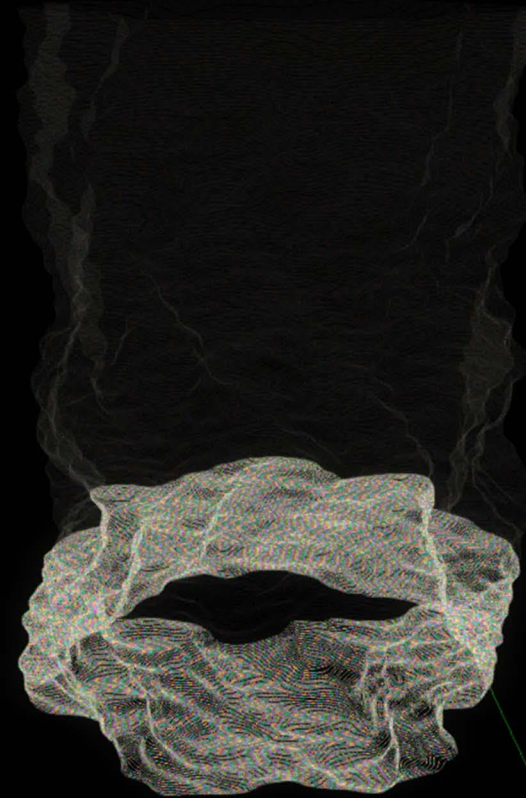

**photo generated through gcode viewer*



mr_visualgrams

Edit Profile



27 posts

343 followers

44 following

mr_visualgrams

Art | Design | Visual Scripting

Professional architectural visualization and Illustrations drawings

POSTS

IGTV

SAVED

TAGGED

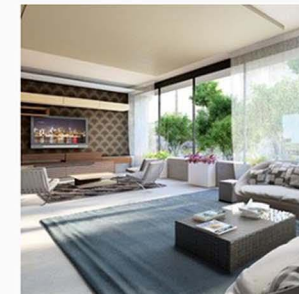
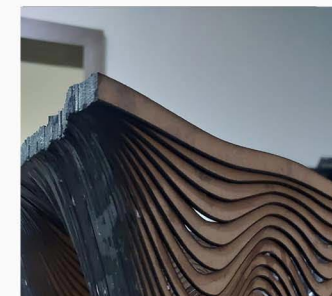
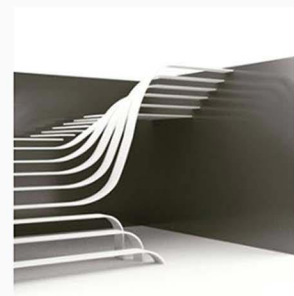
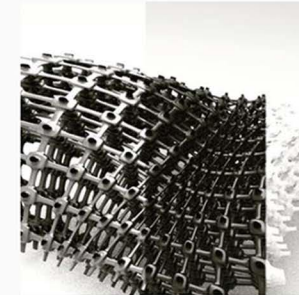

check my Instagram handle @mr_visualgrams



THANKS FOR THE CONSIDERATION